

# VTA-1B

## VALVE TIMER ALARM

### SET-UP AND TECHNICAL MANUAL

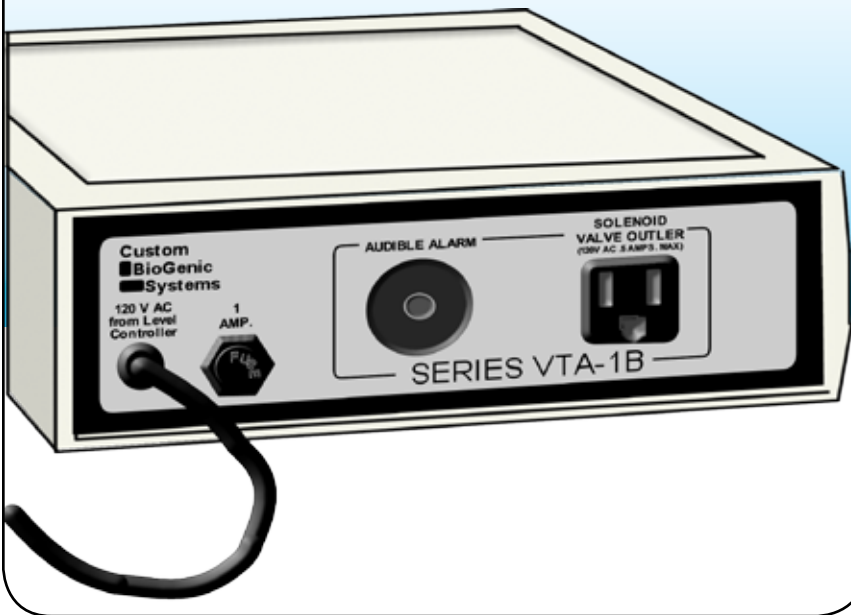

**Custom**  
**BioGenic**  
**Systems**

[www.custombiogenics.com](http://www.custombiogenics.com)

150 Shafer Drive ♦ Romeo, MI 48065 ♦ USA

1.800.523.0072 ♦ Tel: 1.586.331.2600 ♦ Fax: 1.586.331.2588



Leading the World with Innovative Cryopreservation Technology Solutions

## - BEFORE USE -

**Caution:** Do not plug in the AC power plug before completing initial set-up. Check to see that all parts are accounted for and are damage-free.

## - PARTS IDENTIFICATION -

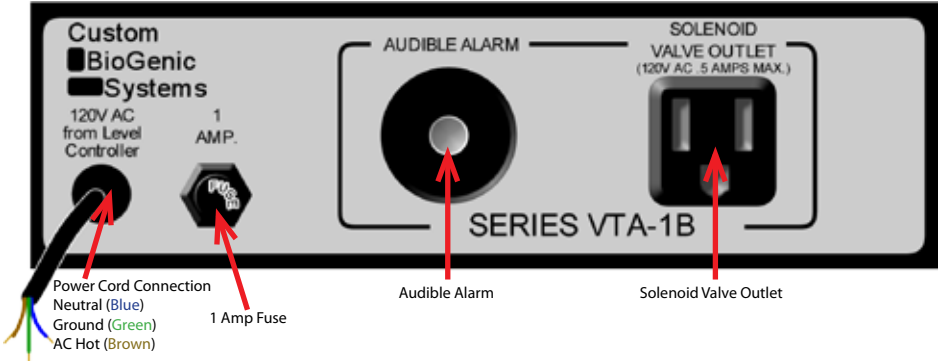

## - CONNECTIONS -

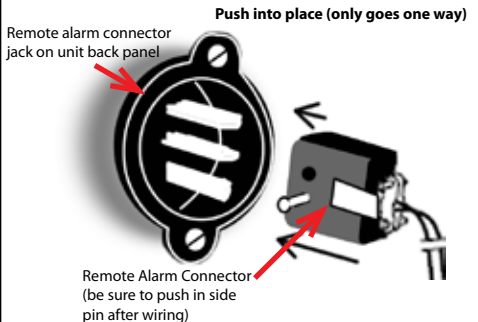
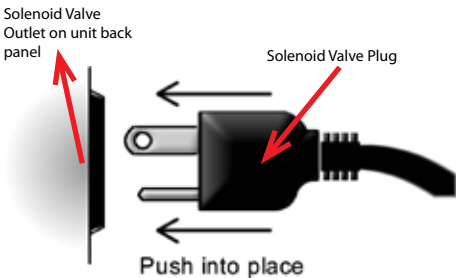

## - INSTALLATION & SETUP -

**Note:** Before beginning installation, be sure that the power cords are unplugged from any power sources and that the LN2 supply valves are closed. Also, be sure a relief valve is installed to avoid LN2 pressure build-up.

The VTA-1B connects into the LN2 system between the level controller and the fill solenoid valve as follows:

1. Unplug the fill solenoid valve from the level controller.
2. Plug the fill valve plug into the solenoid valve outlet on the front of the VTA-1B.
3. Connect the VTA-1B power cord to the level controller either by plugging it into the fill solenoid outlet on the level controller, or by splicing the wires together if necessary (use the illustration at the left to properly identify the wires).
4. Connect the remote alarm if desired.

## - OPERATING PROCEDURE -

When the level controller activates the fill solenoid valve, the VTA-1B will begin timing the valve activation. When the timer reaches the desired valve activation time, it will automatically turn off the solenoid valve and the audible alarm will sound. To reset the VTA-1B, the signal from the level controller to the solenoid valve must be stopped for at least one second (using the manual stop fill on the level controller). If the level control low set point is not satisfied, the fill valve will activate again and the sequence of events will repeat itself. If the level controller is not calling for a fill, the fill solenoid valve and the audible alarm are deactivated until the level controller once again activates the fill solenoid valve.

## - TROUBLESHOOTING GUIDE -

Use this chart to help correct any problems you may encounter. If further assistance is needed, contact your Custom Biogenic Systems representative.

CONDITION	CAUSE	SOLUTION
♦ No Flow of LN2	♦ Blown fuse	♦ Replace with appropriate 1 amp fuse

**AVAILABLE FROM CBS**

**Liquid Nitrogen Equipment Including:**

**Freezers & Dewars**  
**Controlled Rate Freezing Systems**  
**Freezer Racks and Boxes**  
**Transfer Lines**  
**Solenoid Valves**  
**Liquid Level & Temperature Alarms**  
**Liquid Level & Temperature Controls**  
**Temperature Recorders / Monitors**  
**Cryogenic Accessories**



**Custom  
BioGenic  
Systems**

**150 Shafer Drive  
Romeo, Michigan 48065 U.S.A.**

**VTA1B.TM0609**

**Revision: A**

**© 2005 Custom BioGenic Systems**

All designs and materials contained herein are protected under Federal copy right law.  
Unauthorized distribution or use will be subject to prosecution to the fullest extent of the law.